

# Accessories

Series	700
Range	M16 IP40/IP67, HEC
Wire gauge	0,14–0,25; 0,34–0,5; 0,75–1,0 mm <sup>2</sup>
Size of reel	200, 2.000, 4.000, 10.000 pieces
Contact plating	Au



## Crimp Contacts with Gold Contact Plating

- Beside the versions with silver plating there are also versions with gold plating available.
- Both variants are available as single contacts or as reel versions.

# Accessories

Male contact, PU 50 pieces

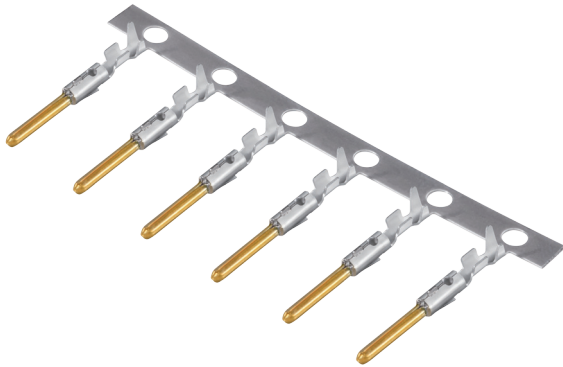
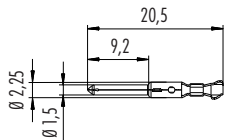

Female contact, PU 50 pieces

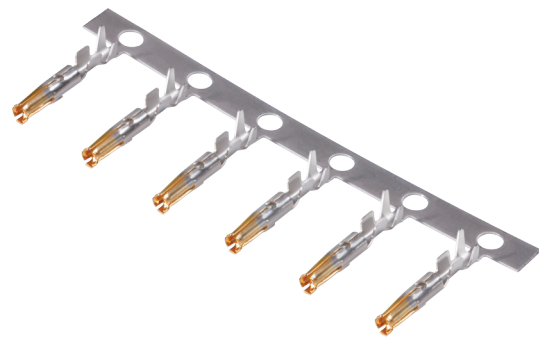
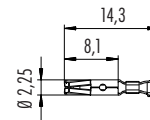

Pin-Ø	Insulating-Ø	Cross section-Ø	PU	Pieces	Ordering-No.
1,5 mm	1,0–2,0 mm	0,14 – 0,25 mm <sup>2</sup>	Single	50	61 0799 098 00
			Strip	200	65 0799 098 01
			Strip	2.000	65 0799 098 02
			Strip	4.000	65 0799 098 04
			Strip	10.000	65 0799 098 10
			Strip	10.000	65 0795 098 10
	1,6–2,1 mm	0,34 – 0,5 mm <sup>2</sup>	Single	50	61 0795 098 00
			Strip	200	65 0795 098 01
			Strip	2.000	65 0795 098 02
			Strip	4.000	65 0795 098 04
			Strip	10.000	65 0795 098 10
			Strip	10.000	65 0796 098 10

Pin-Ø	Insulating-Ø	Cross section-Ø	PU	Pieces	Ordering-No.
1,5 mm	1,0–2,0 mm	0,14 – 0,25 mm <sup>2</sup>	Single	50	61 0800 098 00
			Strip	200	65 0800 098 01
			Strip	2.000	65 0800 098 02
			Strip	4.000	65 0800 098 04
			Strip	10.000	65 0800 098 10
			Strip	10.000	65 0800 098 10
	1,6–2,1 mm	0,34 – 0,5 mm <sup>2</sup>	Single	50	61 0797 098 00
			Strip	200	65 0797 098 01
			Strip	2.000	65 0797 098 02
			Strip	4.000	65 0797 098 04
			Strip	10.000	65 0797 098 10
			Strip	10.000	65 0797 098 10
1,6–2,1 mm	0,75 – 1,0 mm <sup>2</sup>	Single	50	61 0798 098 00	
		Strip	200	65 0798 098 01	
		Strip	2.000	65 0798 098 02	
		Strip	4.000	65 0798 098 04	
		Strip	10.000	65 0798 098 10	
		Strip	10.000	65 0798 098 10	